

Geka G5 Punches & Dies

These are for Geka mini crop & micro crop up to 45 ton

D - Diameter of the head = **30mm**

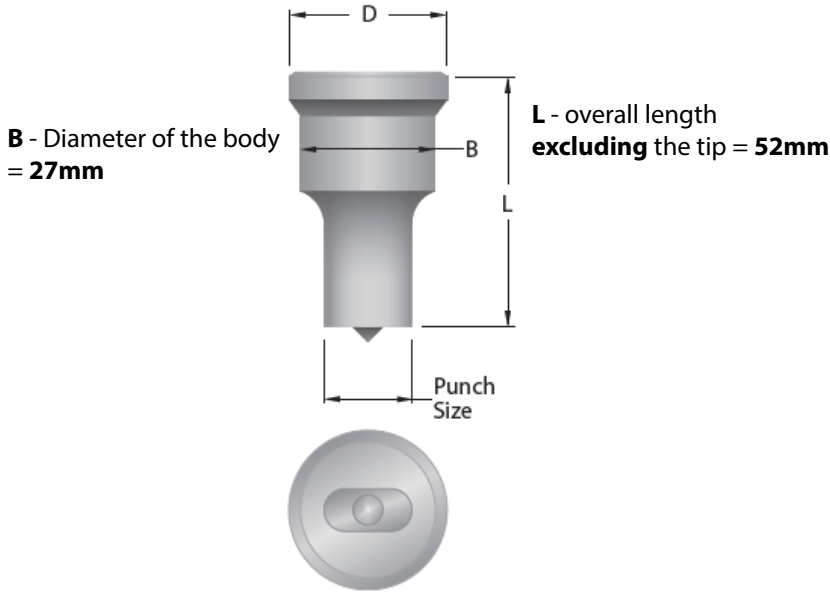

Approx. **50mm** Diameter

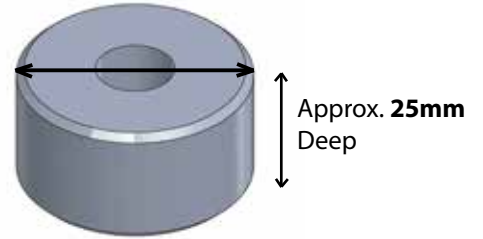

Geka G5 Shaped punches have a 4mm cross

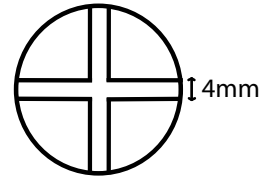

Geka G8 Punches & dies - 55 to 110 ton
 Same as **Kingsland & Sahinler** - 35 to 90 ton
 up to 30mm diameter hole

D - Diameter of the head = **35mm**

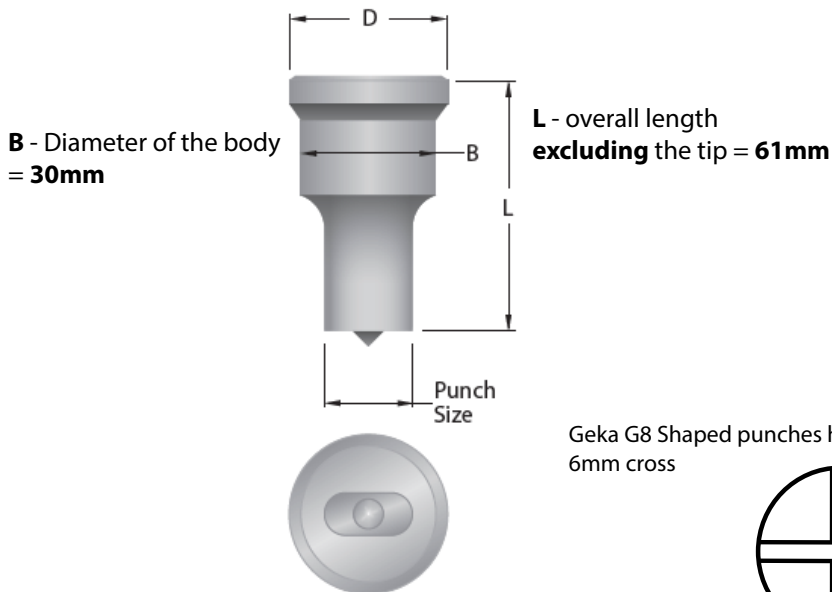

Approx. **60mm** Diameter

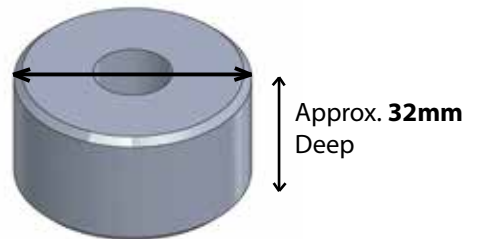

Geka G8 Shaped punches have a 6mm cross

Kingsland Shaped punches have a 4mm slot

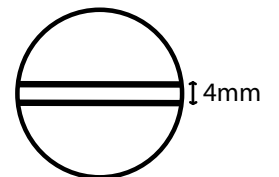
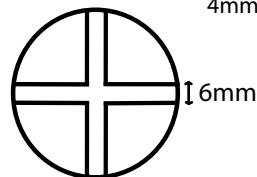

The die is 60mm Diameter but sometimes the customer prefers G5 die because they have an insert in their machine. So always ask if they want the 50mm G5 Die or 60mm G8 Die.

Larger KINGSLAND/SAHINLER 115 to 175 ton

D - Diameter of the head = **44mm**

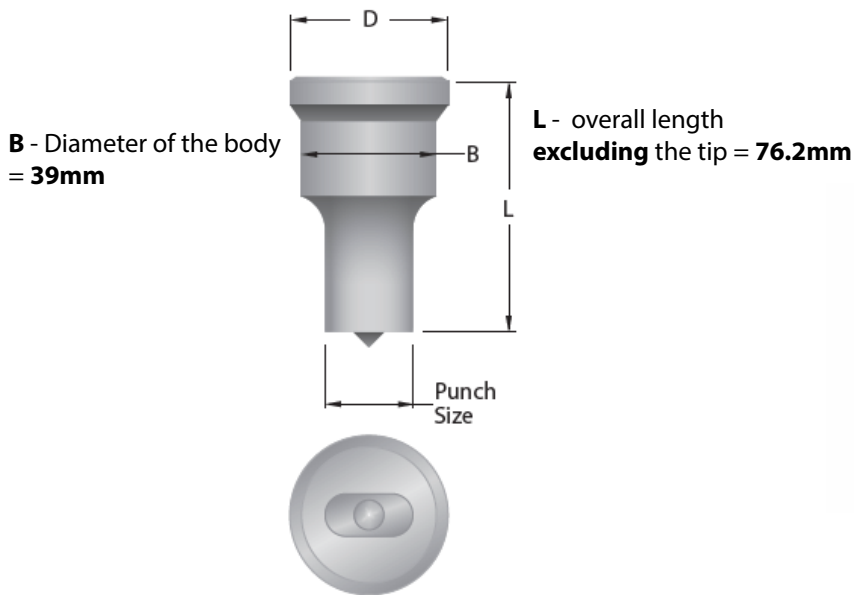

Approx. **60mm** Diameter

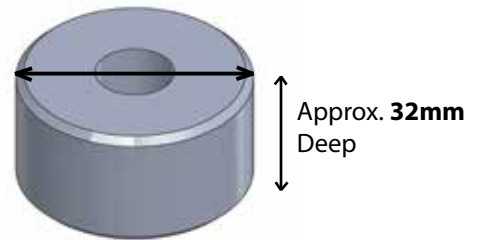

Geka 10 - 150-165 ton up to 40mm diameter holes

D - Diameter of the head = **44mm**

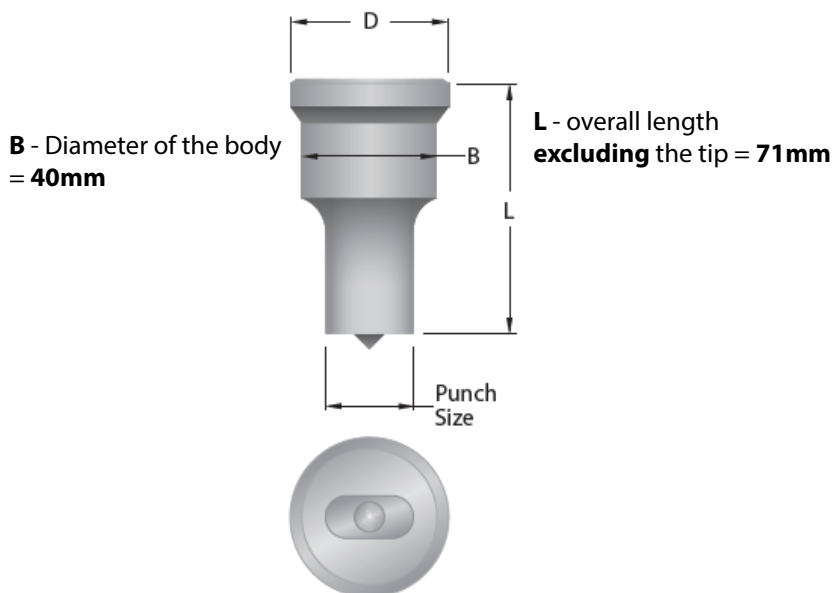

Approx. **73mm** Diameter

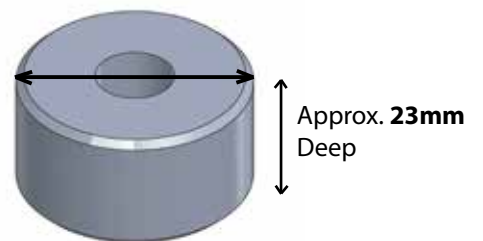

Geka 8-40

D - Diameter of the head = **44mm**

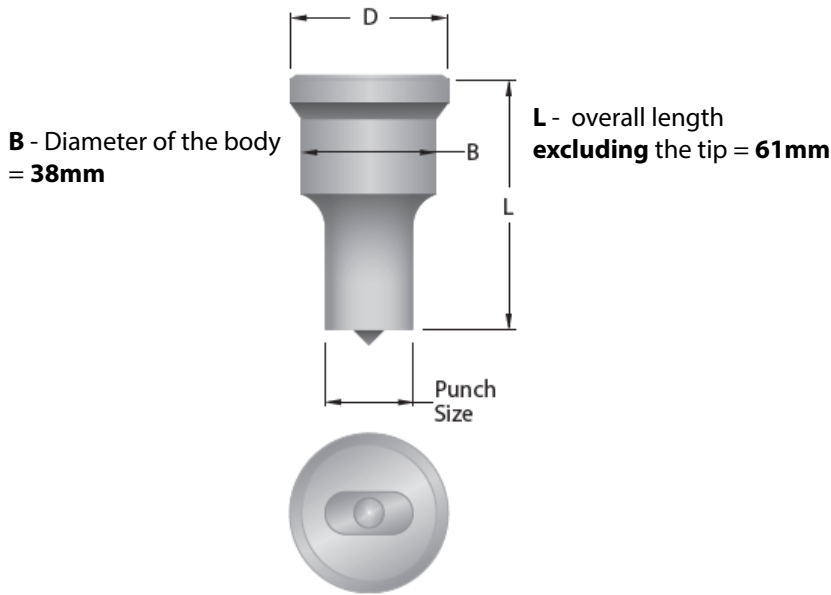

Approx. **60mm** Diameter

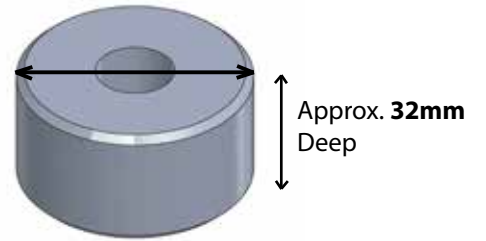

Description of an offset die



Pointy nose



Smiley Face

KINGSLAND/SAHINLER punch for larger diameter hole - up to 38mm Diameter

D - Diameter of the head = **44mm**

B - Diameter of the body = **38mm**

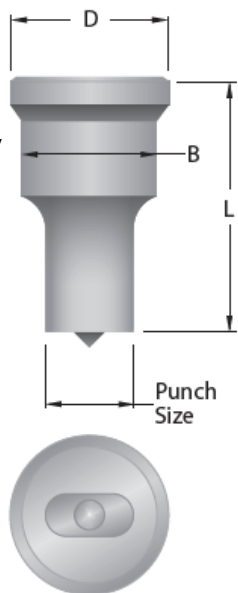

L - overall length **excluding** the tip = **61mm**

Approx. **60mm** Diameter

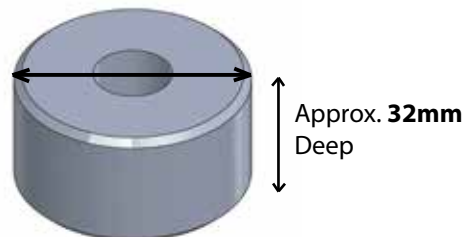

SUNRISE punches - Sometimes classed as Mubea

D - Diameter of the head = **36mm**

B - Diameter of the body = **30mm**

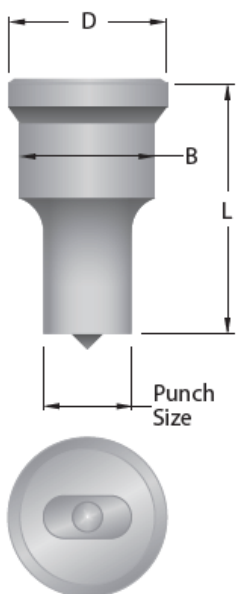

L - overall length **excluding** the tip = **69mm**

Approx. **45mm** Diameter

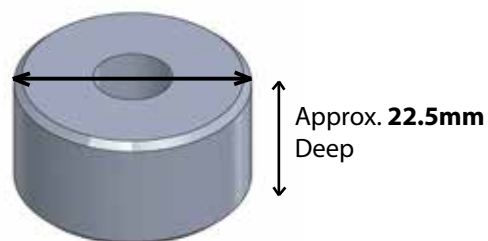

Always ask for the make and model of the machine

UNIMAC 1000 is the same as standard kingsland

Pedinghaus will always be special order

Other Sunrise punches available upon request